



New Jersey Department of Environmental Protection
 Site Remediation and Waste Management Program
CLASSIFICATION EXCEPTION AREA / WELL RESTRICTION
AREA (CEAWRA) FACT SHEET FORM

Date Stamp
 (For Department use only)

SECTION A. SITE INFORMATION

Site Name: Hudson County Chromate Site 114
 Program Interest (PI) Number(s): G000005480, Activity # RPC000051
 Case Tracking Number(s) for this submission: _____

**This form must be attached to the Cover / Certification Form
 if not submitted through the Remedial Phase Report Online Service**

1. Indicate the reason for submission of this form (*see instructions*):

- New CEA Revise CEA Reestablish CEA Existing CEA with no changes
 CEA for historic fill CEA for Historically Applied Pesticides (HAP) CEA lift/removal

If you are submitting this form for an existing CEA provide the CEA Subject Item ID: _____

2. Indicate the type of ground water Remedial Action (RA):

- Natural Active Final RA not yet selected

3. Is this form being submitted with a Remedial Action Permit (RAP) Form (for Soil or Ground Water)? Yes No

SECTION B. CEA COMPONENT AND VAPOR INTRUSION INFORMATION

Name of document that includes the CEA Fate and Transport Description: Not applicable - Historic fill

Date of document: 08/31/2021

1. **Ground Water Classification:** What is the ground water classification within the CEA as per N.J.A.C. 7:9C?

(Check all that apply)

- Class I-A Class II-A
 Class I-PL Pinelands Protection Area Class III-A
 Class I-PL Pinelands Preservation Area Class III-B

2. **Contaminant Data:** This CEAWRA applies only to the contaminants listed below with concentrations above, or assumed to be above, numeric values established for the applicable classification area via the [Ground Water Quality Standards](#) (GWQS), N.J.A.C. 7:9C. Except for historic fill CEAs based on assumed ground water contamination, list the maximum contaminant value for all ground water data that could be representative of **current** conditions for any well or sampling point used to establish the CEA. See form instructions before entering data into the below table.

Contaminant	Concentration ⁽¹⁾	GWQS ⁽²⁾	SWQS ⁽³⁾	GWSL ⁽⁴⁾
Beryllium	4.2	1	-	-
Cadmium	5	4	-	-
3+4-methylphenol	223	50	-	-
Cobalt	189	100	-	-
Mercury	1.3	2	-	-

See Note 1

- Notes: (1) Maximum concentration in Micrograms Per Liter
 (2) New Jersey Ground Water Quality Standards, N.J.A.C. 7:9C-1.7 and 1.9(c)
 (3) [Surface Water Quality Standards](#), N.J.A.C. 7:9B - Applicable only where contaminants in the CEA may discharge to a surface water body.
 (4) Current NJDEP Vapor Intrusion (VI) Ground Water Screening Levels (GWSL) available at <http://www.nj.gov/dep/srp/guidance/vaporintrusion/>

Check if attaching the form Addendum to list additional contaminants and associated information.

3. CEA Boundaries and VI Pathway Status: Year of tax map used: 2013 See Note 2

Are there volatile contaminants in the CEA? Yes No
 Is there LNAPL currently found in the CEA? Yes No

Note 2: Source of block/lot information:
 Parcels of Hudson County, NJ State Plane NAD83,
 Hudson County Dept. of Planning, May 21, 2013, with updates
 based on Sheet 215 of the Tax Map accessed at:
<http://hostedfiles.civilsolutions.biz/jerseycity/taxmaps/index.htm>
 (revised 12/2020). Accessed March 2021.

For CEA revisions only:

- Check if CEA Boundary has changed (See instructions)
 Check if Block and Lot numbers have changed (See instructions)

List the block(s) and lot(s) included in the areal extent of the CEA and check the appropriate boxes:

Block	Lot(s)	Check if off-site	Check if VI pathway was evaluated*	Check if VI pathway status is indeterminate*
21501	16, 17, 18.01, 18.02, 19.01, 19.02	<input type="checkbox"/>	<input type="checkbox"/>	<input type="checkbox"/>
21501	20.01, 20.02	<input type="checkbox"/>	<input type="checkbox"/>	<input type="checkbox"/>
		<input type="checkbox"/>	<input type="checkbox"/>	<input type="checkbox"/>
		<input type="checkbox"/>	<input type="checkbox"/>	<input type="checkbox"/>
		<input type="checkbox"/>	<input type="checkbox"/>	<input type="checkbox"/>
		<input type="checkbox"/>	<input type="checkbox"/>	<input type="checkbox"/>
		<input type="checkbox"/>	<input type="checkbox"/>	<input type="checkbox"/>

Check if attaching an Addendum to list additional Blocks/Lots and associated information. (see instructions)

* Follow instructions for parcels where the vapor intrusion (VI) pathway was evaluated and the status is indeterminate.

Direction of ground water flow: multiple zones/ (If multiple water bearing zones exist within the CEA and/or there is no predominant flow direction, see instructions.) * Refer to Figure 3-5 and Section 3 of the RIR.
 variable

Vertical depth of CEA: 26.6 (ft bgs) and -13.4 (msl). See Exhibit B-2

Horizontal extent of CEA: 16.2 Indicate units: acres or square feet

Name(s) of the affected Geologic Formation(s)/Unit(s) (see instructions if multiple formations/units affected):

Non-native fill layer

Narrative description of proposed CEA boundaries:

The proposed CEA extends to the property boundaries of Block 21501, Lots 16-20.02, and measures approximately 16.2 acres, and extends to a depth of 26.6 ft below ground. The CEA is bounded by the NJ Transit Light Rail property and Forrest Street to the north, Halladay Street to the east, Carteret Avenue to the south, and Garfield Avenue to the west. The contamination is related to the presence of regional historic fill across the Site.

4. Projected Term of CEA: (Based on modeling/calculations in the fate and transport description)

Proposed Duration in Years: _____ Anticipated Expiration Date: _____

or Indeterminate (Review instructions before selecting "Indeterminate" for the CEA duration.)

5. ATTACH AND/OR SUBMIT THE FOLLOWING: (see instructions for additional information/requirements)

Exhibit A: Site Location Maps – Based on USGS Quadrangle Map;

Exhibit B: CEA Map and Cross Section Figure – See N.J.A.C 7:26C- 7.3(c)1 and 2 and instructions regarding what is required to be included on the map and the cross-section figure.

Exhibit C: GIS Deliverables – CEA Boundary Extent Map. The CEA Boundary Extent Map shall be submitted via email to srpgis_cea@dep.nj.gov. (See the instructions for detailed GIS deliverable requirements.)

Identify format of CEA Boundary Extent Map being submitted: Shape File CAD File N/A

If there is a CEA map already on NJ-GeoWeb, does it need to be revised? Yes No N/A

SECTION C. CURRENT GROUND WATER USE DOCUMENTATION Note: Well search is included in the Receptor Evaluation form prepared for the Remedial Investigation Report.

- 1. Indicate the year of the most recent well search completed per N.J.A.C. 7:26E-1.14: 2021
- 2. If this Fact Sheet form is for a revised CEA or an existing CEA with no changes, have new wells been installed since the CEA was established? Yes No N/A
- 3. Are there any pumping wells (e.g., potable, industrial, irrigation or recovery wells) within the foot print of the CEA? Yes No
If "Yes" list/attach list of the type and status of any pumping well(s) within CEA:

SECTION D. WELL RESTRICTION INFORMATION

Certain well restrictions relevant to potable ground water use, such as "Double Case Wells", "Sample Potable Wells", and "Evaluate Production Wells", are consistently set within the boundaries of all CEAs established by the NJDEP in Class I and II-A areas (see instructions).

- 1. Are there any other site-specific well restrictions relevant to potable ground water use that should be set within or near the boundaries of the proposed CEA? Yes No
If "Yes", describe below any such site-specific well restrictions proposed for this CEA:

SECTION E. PUBLIC NOTIFICATION REQUIREMENTS

- 1. Indicate which of the following entities have been notified pursuant to N.J.A.C. 7:26C-7.3(d) and the dates each notification was sent. (check all that apply)
 - Municipal and county clerk(s) Dated mailed: _____
 - Local, county or regional health department(s) Dated mailed: _____
 - Designated County Environmental Health Act agency (if applicable) Dated mailed: _____
 - County Planning Board Dated mailed: _____
 - Pinelands Commission (if applicable) Dated mailed: _____
 - Owners of real property overlying CEA foot print Dated mailed: _____

(Notifications will be sent upon approval of the draft CEA)

ADDENDUM
Classification Exception Area / Well Restriction Area
Fact Sheet Form

Section B. CEA Component and Vapor Intrusion Information

1. **Contaminant Data** (continued): This CEA/WRA applies only to the contaminants listed on page 1 and in the table below with concentrations above, or assumed to be above, numeric values established for the applicable classification area via the GWQS, N.J.A.C. 7:9C. Except for historic fill CEAs based on assumed ground water contamination, list below the maximum contaminant value for all ground water data that could be representative of **current** conditions for any well or sampling point used to establish the CEA. See form Instructions before entering data into the tables below.

Contaminant	Concentration ⁽¹⁾	GWQS ⁽²⁾	SWQS ⁽³⁾	VI GWSL ⁽⁴⁾
Selenium	33.4	40	-	-
Silver	138	40	-	-
Zinc	1,630	2,000	-	-

Notes: ⁽¹⁾ Maximum concentration in Micrograms Per Liter
⁽²⁾ New Jersey Ground Water Quality Standards, N.J.A.C. 7:9C-1.7 and 1.9(c)
⁽³⁾ Surface Water Quality Standards, N.J.A.C. 7:9B - Applicable only where contaminants in the CEA may discharge to a surface water body.
⁽⁴⁾ Current NJDEP Vapor Intrusion (VI) Ground Water Screening Levels (GWSL)

2. **CEA Boundaries and VI Pathway Status** (continued): List additional parcels included in the CEA. Attach additional Addendum sheets if necessary to list all blocks and lots within the CEA.

For CEA revisions, check here if block and lot numbers have changed:

Block	Lot(s)	Check if off-site	Check if VI pathway was evaluated*	Check if VI pathway status is indeterminate*
		<input type="checkbox"/>	<input type="checkbox"/>	<input type="checkbox"/>
		<input type="checkbox"/>	<input type="checkbox"/>	<input type="checkbox"/>
		<input type="checkbox"/>	<input type="checkbox"/>	<input type="checkbox"/>
		<input type="checkbox"/>	<input type="checkbox"/>	<input type="checkbox"/>
		<input type="checkbox"/>	<input type="checkbox"/>	<input type="checkbox"/>
		<input type="checkbox"/>	<input type="checkbox"/>	<input type="checkbox"/>
		<input type="checkbox"/>	<input type="checkbox"/>	<input type="checkbox"/>
		<input type="checkbox"/>	<input type="checkbox"/>	<input type="checkbox"/>
		<input type="checkbox"/>	<input type="checkbox"/>	<input type="checkbox"/>
		<input type="checkbox"/>	<input type="checkbox"/>	<input type="checkbox"/>

* Follow instructions for parcels where the vapor intrusion (VI) pathway was evaluated and status is indeterminate.

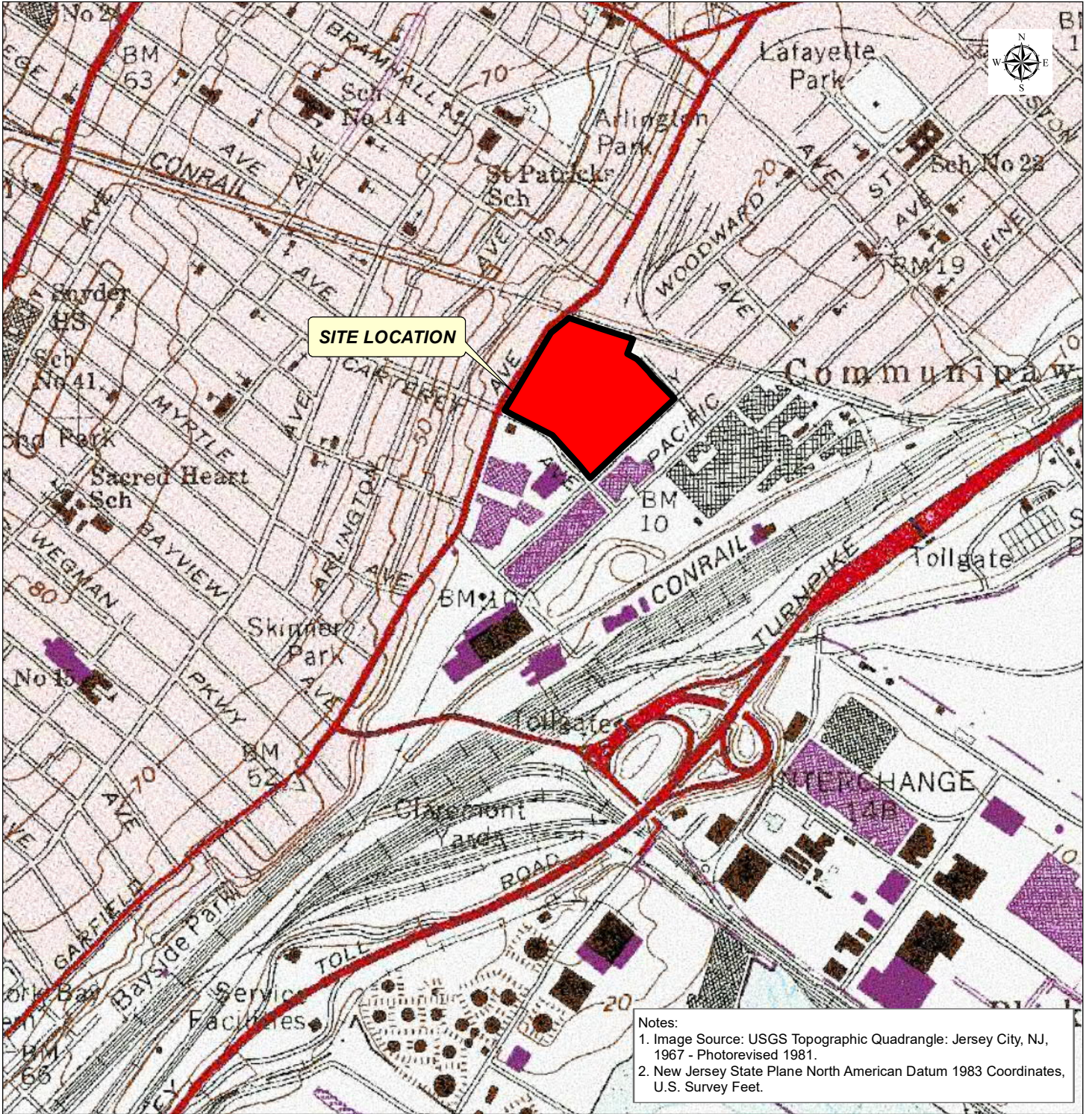

SITE LOCATION

Notes:
 1. Image Source: USGS Topographic Quadrangle: Jersey City, NJ, 1967 - Photorevised 1981.
 2. New Jersey State Plane North American Datum 1983 Coordinates, U.S. Survey Feet.



Legend

 HUDSON COUNTY CHROMATE SITE 114

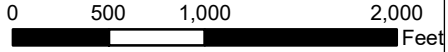

PPG GARFIELD AVENUE GROUP
 SITE 114
 JERSEY CITY, NEW JERSEY
 PROJECT # 60550261
 Date: 12/22/2020 Drawn by: SR Checked by:SG

EXHIBIT A
SITE LOCATION MAP





Notes:
 1. New Jersey State Plane North American Datum 1983 Coordinates (NAD83), U.S. Survey Feet.
 2. Parcels of Hudson County, NJ State Plane NAD83, Hudson County Dept. of Planning, May 21, 2013, with updates based on Sheet 215 of the Tax Map accessed at: <http://hostedfiles.civilsolutions.biz/jerseycity/taxmaps/index.htm> (revised 12/2020). Accessed March 2021.
 CEA = Classification Exception Area

Last Saved By: ravis Document Path: Q:\PPG - GDS\920 GIS\MXD\Groundwater\FIR\CEA\Historic Fill_CEA\Exhibit B-1 SitePlan_CEA Boundary.mxd

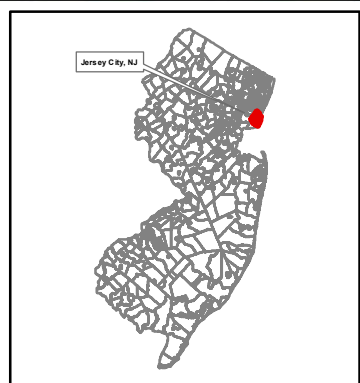

LEGEND

- HUDSON COUNTY PARCELS
- RAILROAD TRACKS
- PROPERTY LINES
- HISTORIC FILL CEA BOUNDARY

➔ DIRECTION OF GROUNDWATER FLOW

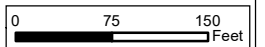

PPG
 GARFIELD AVENUE GROUP
 JERSEY CITY, NEW JERSEY
 60550261

EXHIBIT B-1
 SITE PLAN AND
 CEA BOUNDARY

DATE: 3/22/2021 DRAWN BY: SR CHECKED BY:

File: Q:\20 SHEETS\GW\2021 Site 114 GW RIR\CAD\2021-01-14 Site 114 GW RIR.dwg Layout: FIGURE 1 User: John.Angelone Plotted: Feb 04, 2021 - 12:31pm Xref's:

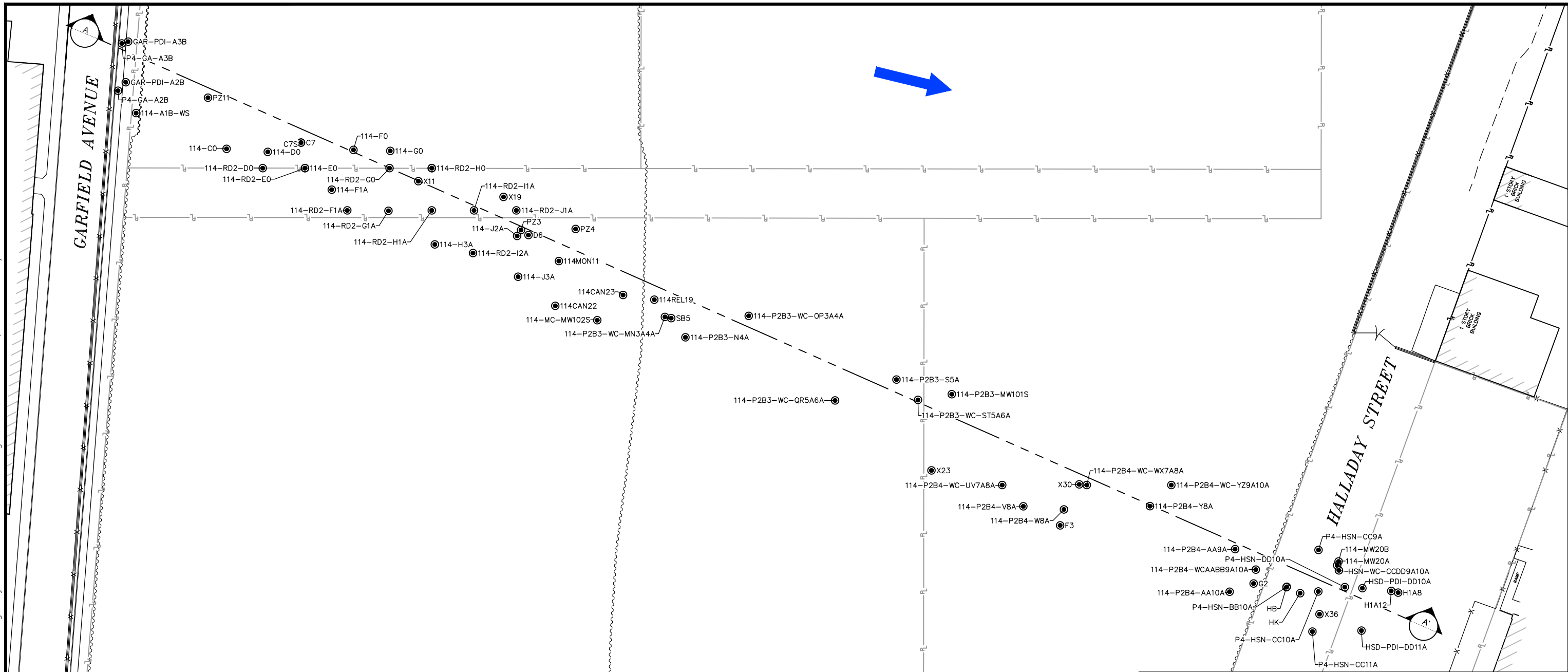

LEGEND

- EXISTING PROPERTY LINE
- FENCE
- EDGE OF PAVEMENT
- EDGE OF CONCRETE
- EXISTING SHEET PILE
- CURB
- DEPRESSED CURB
- CONCRETE WALL
- EXISTING BUILDING
- PRE-CONSTRUCTION ELEVATION CONTOURS 1' INTERVAL 5' INDEX
- BORING/MONITORING WELL/ TEST PIT/POST-EXCAVATION SAMPLE LOCATION
- GROUNDWATER FLOW DIRECTION ARROW

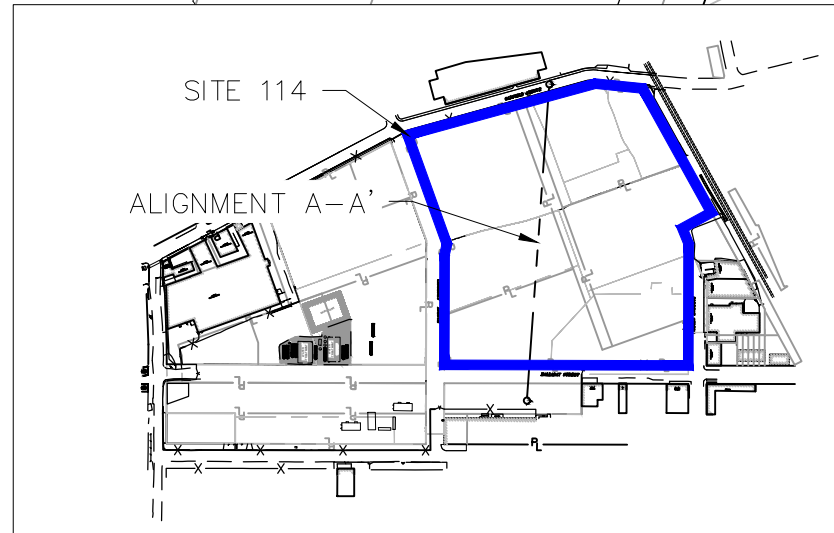
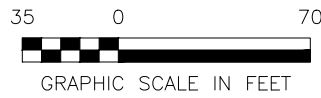

<p>PPG GARFIELD AVENUE GROUP SITES JERSEY CITY, NEW JERSEY</p>		<p>HISTORIC FILL - SITE 114 PLAN VIEW</p>
DATE: 02/04/2021	DRWN: ASK	EXHIBIT B-2A

File: Q:\20 SHEETS\GW\2021 Site 114 GW RIR\CAD\2021-01-14 Site 114 GW RIR.dwg Layout: FIGURE 2 User: John.Angelone Plotted: Feb 04, 2021 - 12:28pm Xref's:

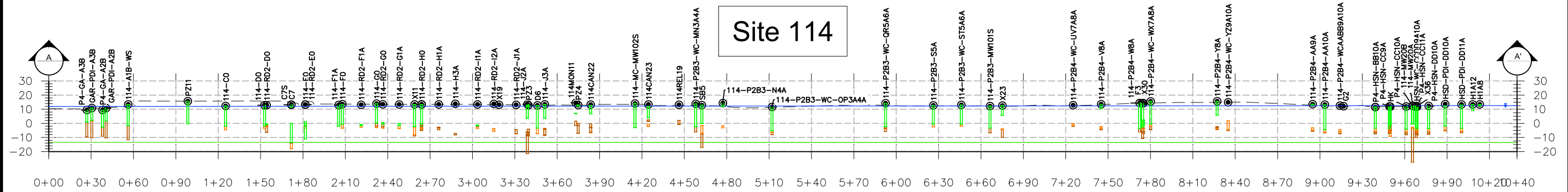

LEGEND

- EXISTING GROUND SURFACE
- GROUNDWATER ELEVATION/ UPPER LIMIT OF CEA
- LOWER LIMIT OF CEA
- █ FILL OBSERVED IN BORING
- █ MM OBSERVED IN BORING
- █ UND OBSERVED IN BORING
- BORING/MONITORING WELL/ TEST PIT/POST-EXCAVATION SAMPLE LOCATION

- NOTES:
- ELEVATION VERTICAL DATUM IS NAVD88, IN US SURVEY FT.
 - CEA CLASSIFICATION EXCEPTION AREA
 - FT FEET
 - MM MEADOW MAT
 - NAVD88 NORTH AMERICAN VERTICAL DATUM OF 1988
 - UND UNDISTURBED NATIVE DEPOSIT



PPG GARFIELD AVENUE GROUP SITES JERSEY CITY, NEW JERSEY		HISTORIC FILL - SITE 114 PROFILE VIEW
DATE: 02/04/2021	DRWN: ASK	EXHIBIT B-2B