

File: A:\Rem\_Eng\Project Files\PPG Industries\Garfield Avenue\2014\PPG - 2014 Design\BMP-C-01.dwg Layout: PZ Site Prep User: warner Plotdate: Oct 10, 2014 - 2:41pm Xref's:

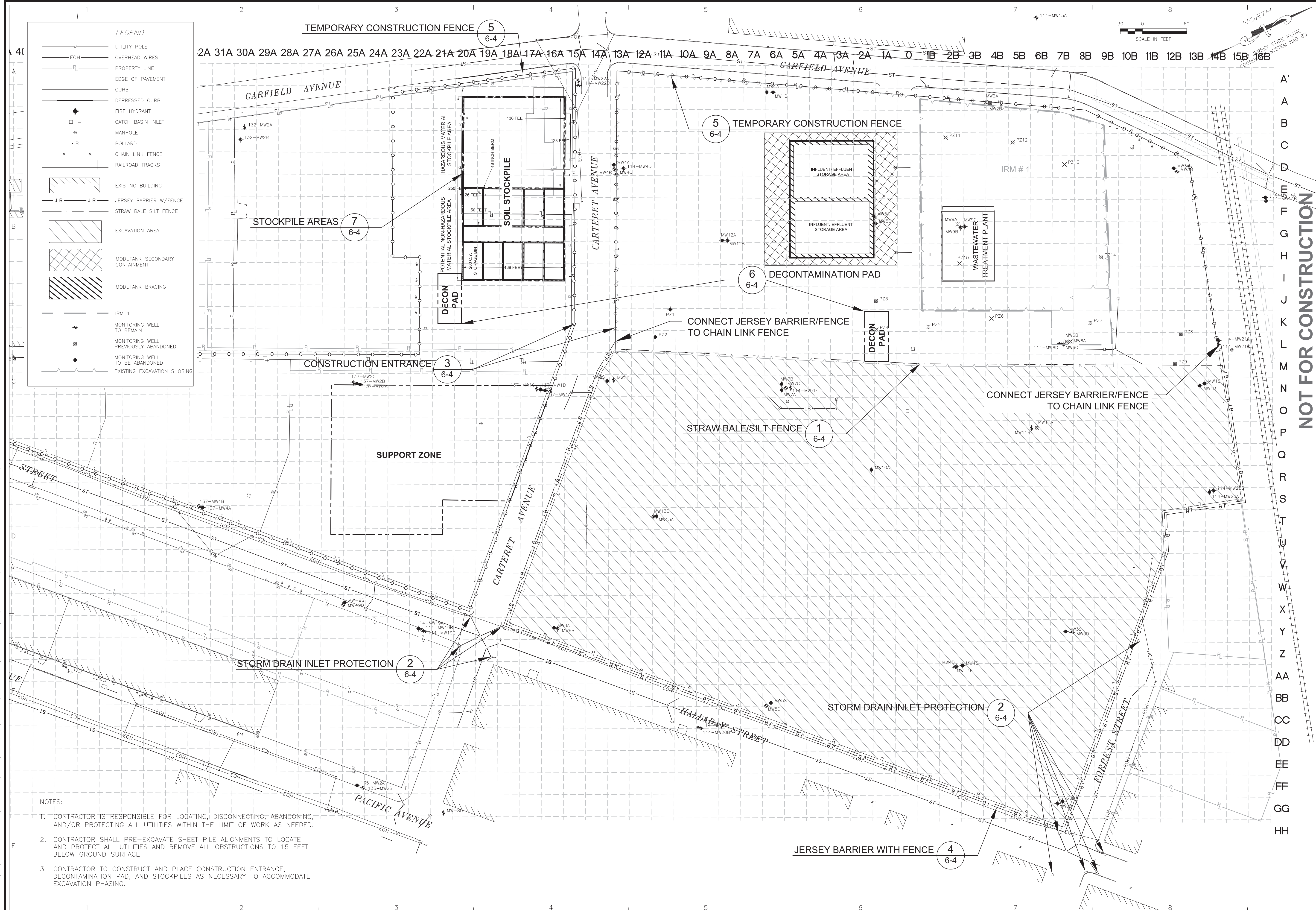

LEGEND	
	UTILITY POLE
	OVERHEAD WIRES
	PROPERTY LINE
	EDGE OF PAVEMENT
	CURB
	DEPRESSED CURB
	FIRE HYDRANT
	CATCH BASIN INLET
	MANHOLE
	BOLLARD
	CHAIN LINK FENCE
	RAILROAD TRACKS
	EXISTING BUILDING
	JERSEY BARRIER W/FENCE
	STRAW BALE SILT FENCE
	EXCAVATION AREA
	MODUTANK SECONDARY CONTAINMENT
	MODUTANK BRACING
	IRM 1
	MONITORING WELL TO REMAIN
	MONITORING WELL PREVIOUSLY ABANDONED
	MONITORING WELL TO BE ABANDONED
	EXISTING EXCAVATION SHORING

- NOTES:**
1. CONTRACTOR IS RESPONSIBLE FOR LOCATING, DISCONNECTING, ABANDONING, AND/OR PROTECTING ALL UTILITIES WITHIN THE LIMIT OF WORK AS NEEDED.
  2. CONTRACTOR SHALL PRE-EXCAVATE SHEET PILE ALIGNMENTS TO LOCATE AND PROTECT ALL UTILITIES AND REMOVE ALL OBSTRUCTIONS TO 15 FEET BELOW GROUND SURFACE.
  3. CONTRACTOR TO CONSTRUCT AND PLACE CONSTRUCTION ENTRANCE, DECONTAMINATION PAD, AND STOCKPILES AS NECESSARY TO ACCOMMODATE EXCAVATION PHASING.

**NOT FOR CONSTRUCTION**

C	RCW	10/10/14	FINAL RAMP EDITS	C.W.M.12/05/11 H.N.Q.12/06/11
B	R.M.T.12/05/11	NO DEF COMMENT EDITS		
A	RCW	05/16/11	RAMP	
NO	DRW	DATE	REVISION	APPROVAL DATE

**AECOM**  
 20 Hightstown Road, Suite 200  
 Hightstown, NJ 08520  
 www.aecom.com

**PPG INDUSTRIES**  
 GARFIELD AVENUE SITES  
 JERSEY CITY, HUDSON COUNTY, NEW JERSEY

PROJ. NO.: 60190341.500A DATE: 10/10/14

**CONCEPTUAL PHASE 2**  
**SITE PREPARATION**  
**AND EROSION CONTROL**  
 WORK PLAN

DRAWING NUMBER:  
**6-2**

SHEET NUMBER:  
**C**