

**LEGEND**

- P — PROPERTY LINE
- - - EDGE OF PAVEMENT
- C — CURB
- D — DEPRESSED CURB
- S — SHORING TO REMAIN IN-PLACE
- X — CHAIN LINK FENCE
- R — RAILROAD TRACKS
- ▨ EXISTING BUILDING
- COMPLETED EXCAVATION

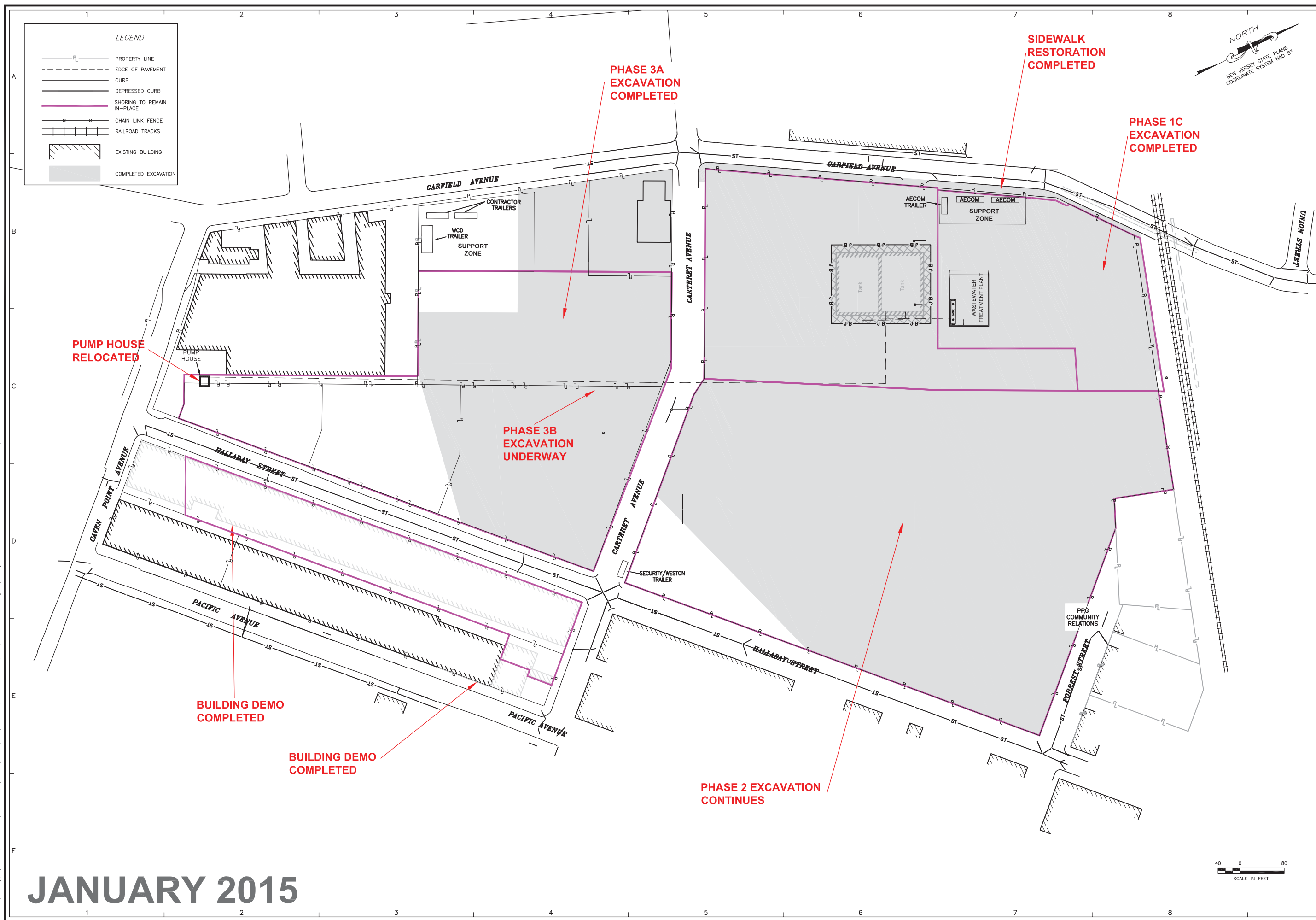
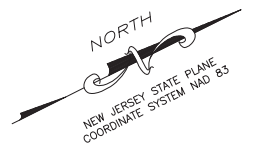

NO	DRWN/DATE	REVISION	CHKD/DATE	APPVD/DATE
2	RCW 10/10/14	REVISED FINAL RAMP EDITS	HNQ 05/06/14	JAF 05/06/14
1	RM 05/06/14	FINAL RAMP EDITS	HNQ 05/06/14	JAF 05/06/14

**AECOM**  
 30 Fellowship Road, Suite 600  
 Piscataway, NJ 08854  
 www.aecom.com

PPG INDUSTRIES  
 GARFIELD AVENUE SITES  
 JERSEY CITY, HUDSON COUNTY, NEW JERSEY

PROJ. NO.: 60190341.500A DATE: 10/10/14

**GARFIELD AVENUE GROUP  
 REMEDIAL PROGRESS PLAN**

REMEDIAL ACTION WORK PLAN

FIGURE NUMBER:	17-8
SHEET NUMBER:	
REVISION:	2

**JANUARY 2015**

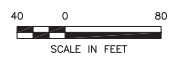

File: A:\Rem\_Eng\Project Files\PPG Industries\Garfield Avenue\1802 Design\CAD\DWG\1802 PPG - CAC Rem Sequence\1802-2014-05-12.dwg Layout: Figure 17-8 User: rnormer Plotfile: Oct 10, 2014 - 2:52pm Xref's: