

Path: F:\Projects\PPG\SITE 156 - METRO TOWERS\7-Deliverables\7.2-Reports-Drafts\20180303 GW RIR\Figures\F3 GW 20180303.mxd

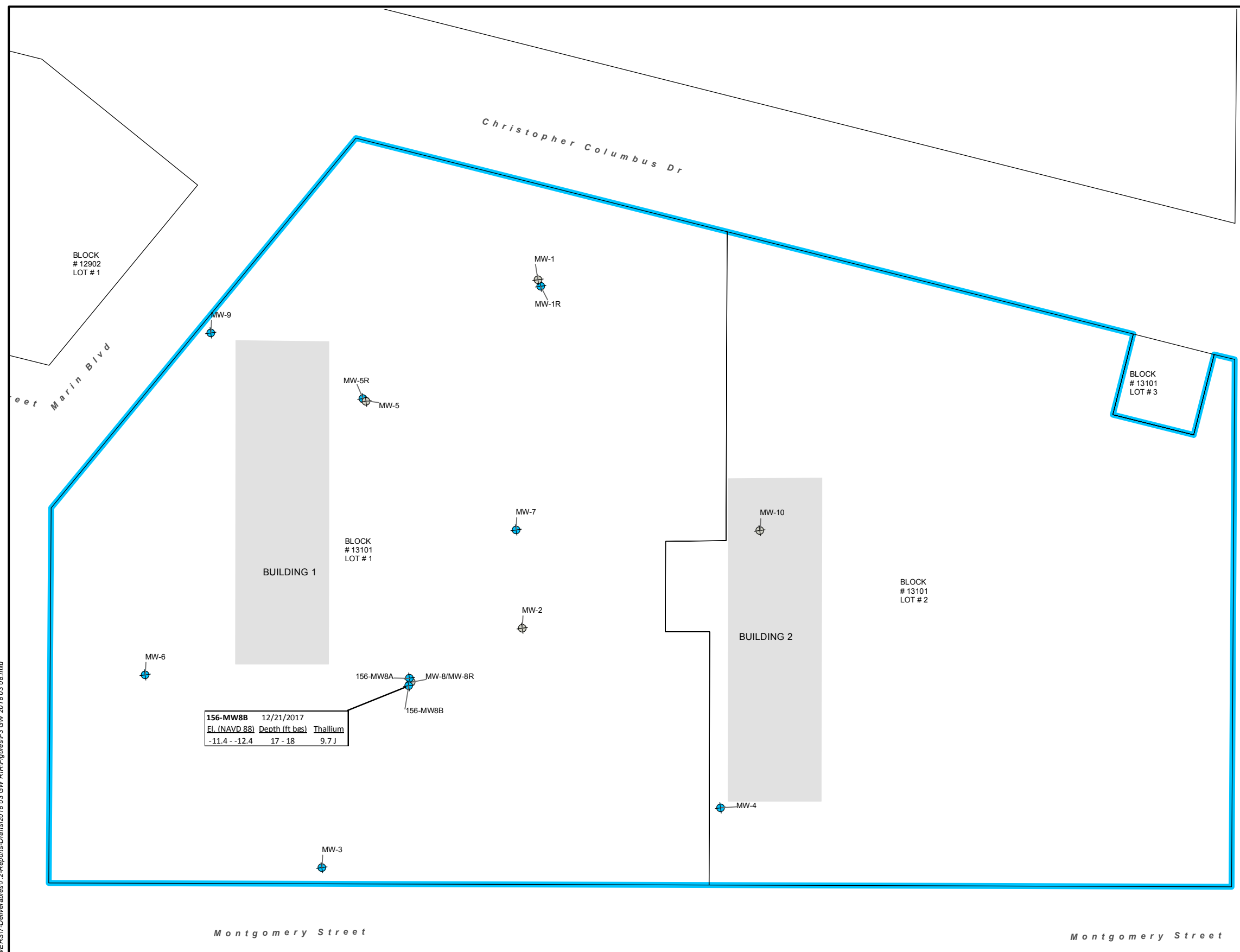

156-MW8B	12/21/2017
El. (NAVD 88)	Depth (ft bgs)
-11.4 - -12.4	17 - 18
	Thallium
	9.7J

ABBREVIATIONS:
 bgs - below ground surface
 CCPW - Chromate Chemical Production Waste
 El. - elevation
 ft - feet
 GWQS - Ground Water Quality Standard
 IRIS - Integrated Risk Information System
 µg/l - micrograms per liter
 N/A - not applicable
 NAVD 88 - North American Vertical Datum of 1988
 N.J.A.C. - New Jersey Administrative Code
 USEPA - United States Environmental Protection Agency

QUALIFIERS:
 J - The result was an estimated value; the associated numerical value was an approximate concentration of the analyte in the sample.

GENERAL NOTES:
 G1. The CCPW metals data associated with the sample locations shown on this figure are provided in Table 3. Data presented in call out boxes on this figure are outliers (i.e., data points that require further explanation).
 G2. Results are reported in µg/l.
 G3. Source of block/lot information is Jersey City Parcel Data from New Jersey Geographic Information Network (NJ GIN), last updated 10/6/2015 (available at: <http://data.jerseycitynj.gov/dataset/jersey-city-parcel-polygon>).
 G4. The GWQS for vanadium pentoxide is shown. A GWQS has not been established for total vanadium. The USEPA IRIS database, which is incorporated into N.J.A.C. 7:9D by reference, has not assigned a Carcinogenic Slope Factor or Reference Dose for vanadium and a GWQS cannot be

Legend

- MONITORING WELL, EXISTING
- MONITORING WELL, ABANDONED
- BUILDING
- PROPERTY BOUNDARY
- SITE BOUNDARY

Analyte	GWQS (µg/L)
ANTIMONY	6
CHROMIUM	70
HEXAVALENT CHROMIUM	N/A
NICKEL	100
THALLIUM	2
VANADIUM	60

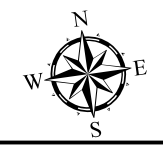

PPG
 SITE 156
 METROPOLIS TOWERS
 JERSEY CITY, NEW JERSEY

DATE: 6/11/2018 DRWN: CH

SITE 156
SAMPLE MAP FOR CCPW METALS
COMPARED TO GWQS

FIGURE: 3