

File: A:\Rem_Eng\Project Files\PPG Industries\Garfield Avenue\2014\PPG - 2014 Design\BMP C-01.dwg Layout: PPI Site Prep User: warner Plotdate: Oct 10, 2014 - 2:41pm Xref's:

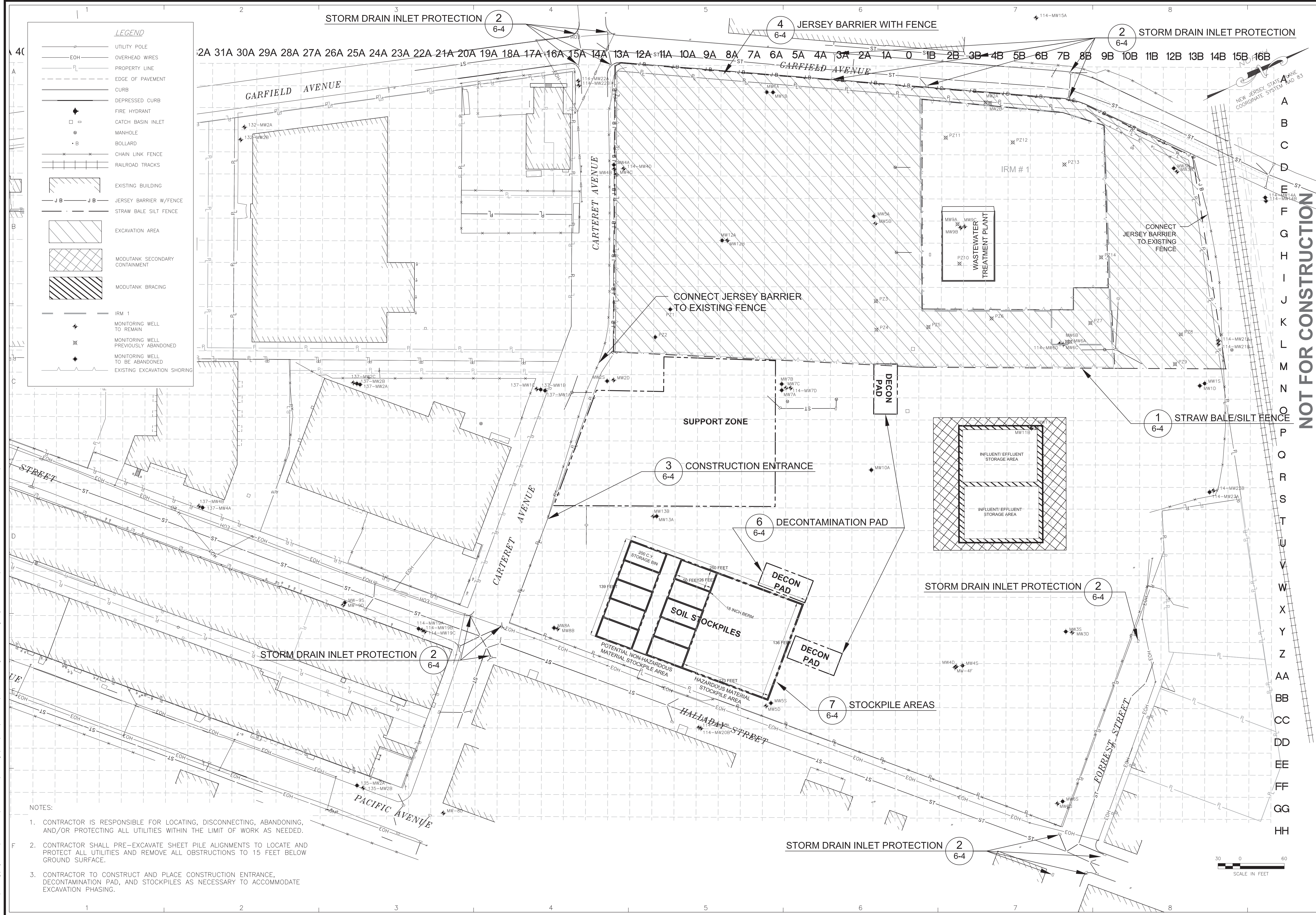

NOT FOR CONSTRUCTION

NO	DRWN/DATE	REVISION	CHKD/DATE	APPRV/DATE
A	RCW 10/05/16/11	RAWP		
B	R.M.T.12/05/11	NO DEF COMMENT EDITS		
C	RCW 10/10/14	FINAL RAMP EDITS		
			C.W.M.12/05/11	M.N.Q.12/06/11

AECOM
 20 Poplarside Road, Suite 200
 Piscataway, NJ 08854
 www.aecom.com

PPG INDUSTRIES
 GARFIELD AVENUE SITES
 JERSEY CITY, HUDSON COUNTY, NEW JERSEY

PROJ. NO.: 60190341.500A DATE: 10/10/14

**CONCEPTUAL PHASE 1
 SITE PREPARATION
 AND EROSION CONTROL
 REMEDIAL ACTION
 WORK PLAN**

DRAWING NUMBER:
6-1

SHEET NUMBER:
 REVISION **C**