

File: A:\Rem_Eng\Project Files\PPG Industries\Garfield Avenue\17-5 Design\17-5-05-12.dwg Layout: Figure 17-5 User: norman Plotfile: Oct 10, 2014 - 2:25pm Xref's:

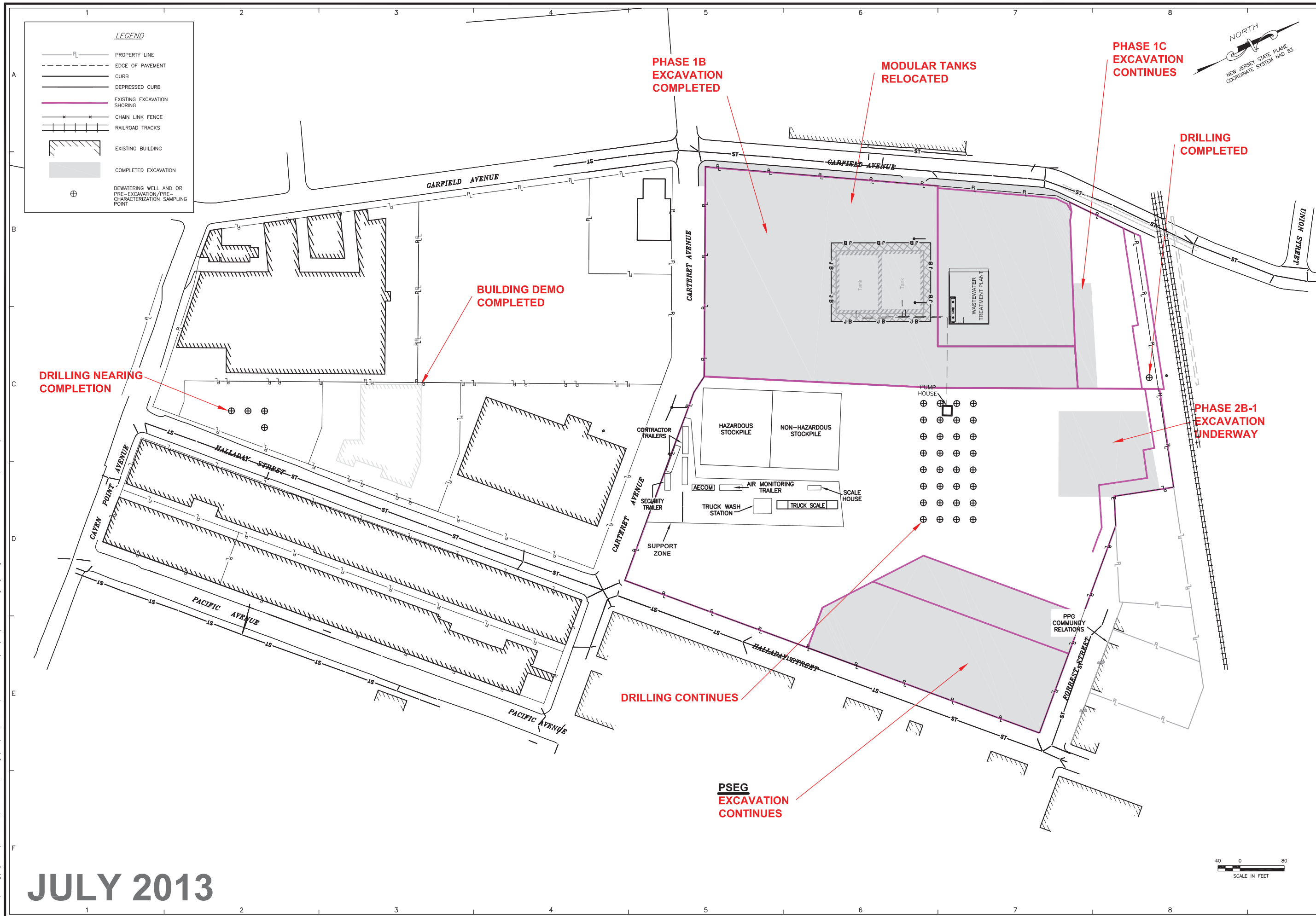

JULY 2013

NO	DRWN/DATE	REVISION	CHKD/DATE	APPVD/DATE
1	RM	05/06/14	AF	05/06/14
2	RCW	10/10/14	REVISED FINAL RAMP EDITS	
1	RM	05/06/14	FINAL RAMP EDITS	

AECOM
 30 Pollock/Kellogg Road, Suite 620
 Piscataway, NJ 08854
 www.aecom.com

PPG INDUSTRIES
 GARFIELD AVENUE SITES
 JERSEY CITY, HUDSON COUNTY, NEW JERSEY

PROJ. NO.: 60190341.500A DATE: 10/10/14

**GARFIELD AVENUE GROUP
 REMEDIAL PROGRESS PLAN**

REMEDIAL ACTION WORK PLAN

FIGURE NUMBER:
17-5

SHEET NUMBER:
2

REVISION: 2