

SITE 114

Block 21501
Lot 18.01

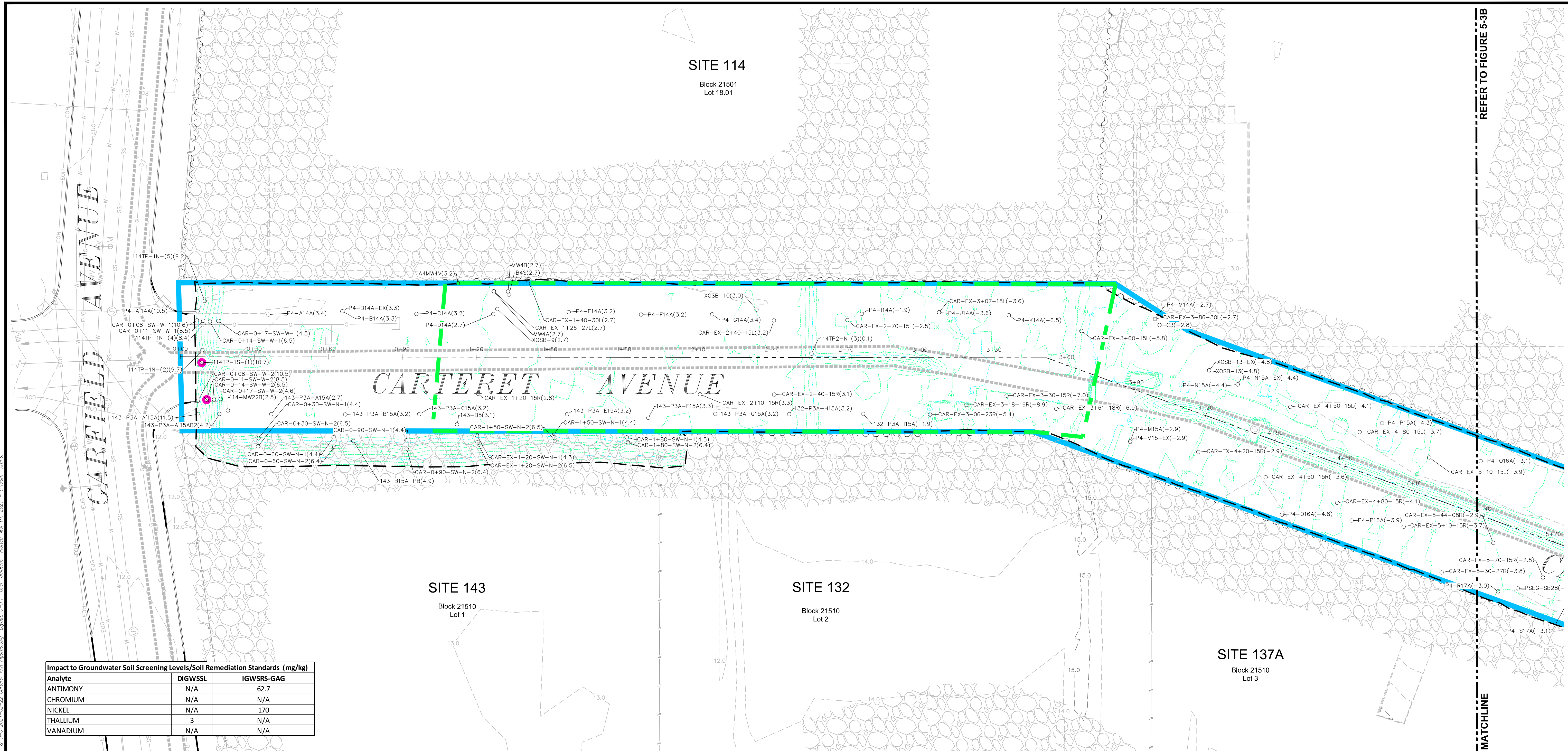

REFER TO FIGURE 5-3B

MATCHLINE

Analyte	DIGWSSL	IGWRS-GAG
ANTIMONY	N/A	62.7
CHROMIUM	N/A	N/A
NICKEL	N/A	170
THALLIUM	3	N/A
VANADIUM	N/A	N/A

	PROPERTY LINE		CATCH BASIN INLET
	FENCE		FIRE HYDRANT
	EDGE OF CONCRETE		WATER VALVE
	EXISTING SHEET PILE		PRE-EXCAVATION GROUND
	CURB		SURFACE ELEVATION CONTOURS 1' INTERVAL 5' INDEX
	EXISTING BUILDING		POST-EXCAVATION ELEVATION CONTOURS 1' INTERVAL 5' INDEX
	GAS UTILITY LINE		STONE
	WATER UTILITY LINE		RESTRICTED-USE AREA (REFER TO FIGURE 5-1A)
	UNDERGROUND ELECTRIC UTILITY LINE		SITE BOUNDARY
	SEWER UTILITY LINE		
	COMMUNICATION UTILITY LINE		
	96\"/>		
	COMBINED SEWER MANHOLE		

SITE 143

Block 21510
Lot 1

SITE 132

Block 21510
Lot 2

SITE 137A

Block 21510
Lot 3

ABBREVIATIONS:

CCPW	CHROMATE CHEMICAL PRODUCTION WASTE
DIGWSSL	NJDEP DEFAULT IMPACT TO GROUNDWATER SOIL SCREENING LEVELS
ft	FEET
IGW	IMPACT TO GROUNDWATER
IGWRS-GAG	IMPACT TO GROUNDWATER SOIL REMEDIATION STANDARD GARFIELD AVENUE GROUP (SITE SPECIFIC ALTERNATIVE REMEDIATION STANDARD AS PROPOSED IN THE SUPPLEMENTAL SOIL REMEDIATION INVESTIGATION REPORT, FINAL DRAFT, DATED 09/17/17)
mg/kg	MILLIGRAMS PER KILOGRAM
N/A	NOT APPLICABLE
NAVD88	NORTH AMERICAN VERTICAL DATUM OF 1988
NJDEP	NEW JERSEY DEPARTMENT OF ENVIRONMENTAL PROTECTION
RL	REPORTING LIMIT
U.S.	UNITED STATES

GENERAL NOTES:

- G1. THE CCPW METALS DATA ASSOCIATED WITH THE SAMPLE LOCATIONS SHOWN ON THIS FIGURE ARE PROVIDED IN TABLE 5-3.
- G2. 'DEPTH' REFERS TO THE DIFFERENCE BETWEEN THE SAMPLE ELEVATION AND THE PRE-REMEDIATION SURFACE ELEVATION FOR SAMPLES COLLECTED FROM THE EXCAVATION PIT BOTTOM, OR THE SAMPLE DEPTH FROM THE SURFACE AT THE SAMPLE LOCATION WHEN THE SAMPLE WAS COLLECTED VIA BORING OR TEST PIT.
- G3. ELEVATION VERTICAL DATUM IS NAVD88, IN U.S. SURVEY FT.
- G4. RESULTS ARE REPORTED IN MG/KG.
- G5. THIS FIGURE PRESENTS DATA FOR LOCATIONS WITHIN THE SITE BOUNDARY THAT HAVE SAMPLES REMAINING IN CONFIRMATION OR THAT HAVE REMOVED SAMPLES THAT SERVE AS CONFIRMATION SAMPLES. SELECT OFF-SITE LOCATIONS ARE PRESENTED IN THIS FIGURE TO DOCUMENT COMPLIANCE WITH THE REMEDIATION OBJECTIVES OR TO DOCUMENT DELINEATION. SPECIFIC NOTES ON TABLE 5-3 INCLUDE DISCUSSION OF THESE SITUATIONS, IF NECESSARY.
- G6. 'STATION' REFERS TO A SAMPLE'S LOCATION ALONG THE EXCAVATION'S CENTERLINE, WHICH RUNS THE LENGTH OF CARTERET AVENUE STARTING FROM THE WESTERMOST EDGE OF CARTERET AVENUE.

SPECIFIC NOTES:

- S1. AT CAR-0+11-SW-W-2 THE THALLIUM RESULT WAS LESS THAN THE RL, BUT THE RL IS GREATER THAN THE DIGWSSL.
- S2. PRE-CONSTRUCTION TOPOGRAPHIC CONTOURS, PROPERTY LINES, BUILDING EXTENTS, AND SITE FEATURES ARE SOURCED FROM SURVEYS CONDUCTED BETWEEN NOVEMBER 2006 AND JULY 2014 BY BORBAS SURVEYING AND MAPPING, LLC.
- S3. UNDERGROUND UTILITIES SHOWN ARE BASED ON THE CATCH BASIN-RECEPTOR EVALUATION SURVEY, PPG SITE 114, THE CITY OF JERSEY CITY, HUDSON COUNTY, NEW JERSEY, CONDUCTED BY BORBAS SURVEYING AND MAPPING, LLC, DATED APRIL 15, 2011, AND ON PLANS PROVIDED BY THE CITY OF JERSEY CITY.
- S4. POST-EXCAVATION ELEVATION SURVEY POINTS WERE SOURCED FROM 'AS-BUILT EXCAVATION SURVEY, CARTERET AVE SITE EXCAVATION, CITY OF JERSEY CITY, HUDSON COUNTY, N.J.' CONDUCTED BY BORBAS SURVEYING AND MAPPING, LLC, DATED JANUARY 27, 2021.
- S5. SAMPLE LOCATIONS ARE ADJACENT TO EACH OTHER AT STATION 3+80, OFFSET 18L; STATION 3+67, OFFSET 30L; STATION 3+95, OFFSET 20R; STATION 4+15, OFFSET 18L; AND STATION 4+28, OFFSET 16L. THEREFORE, THE SAMPLE LOCATION SYMBOLS OVERLAP ON THE FIGURE.

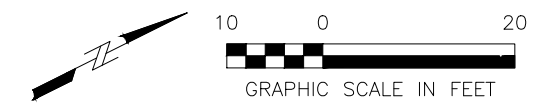
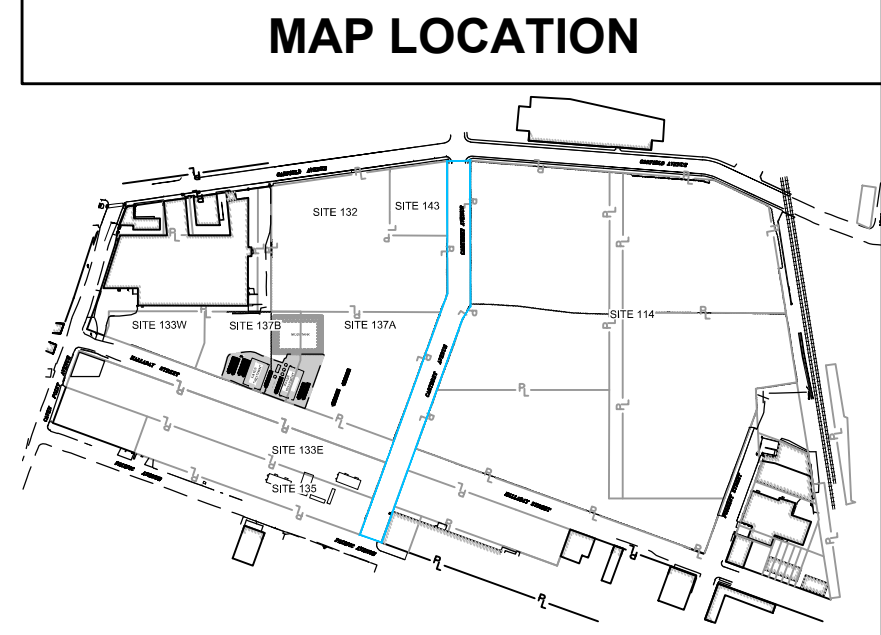

<p>PPG GARFIELD AVENUE GROUP SITES JERSEY CITY, NEW JERSEY</p>		<p>SAMPLE MAP FOR CCPW METALS COMPARED TO IGW SOIL SCREENING LEVELS AND IGW SOIL REMEDIATION STANDARDS</p>
DATE: 02/26/2021	DRWN: JJA	FIGURE 5-3A